

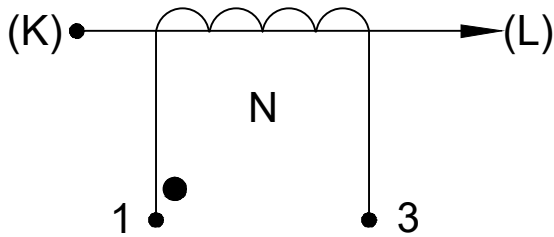

Product Type	PCB Mountable Current Transformer		
GT Part Number	L01-6230 to 6234	Index	
Customer Part Number	-----		
Customer	SCHUKAT		
Place of Manufacture	GT Electronic India		

Page: 01 / 01

SCHEMATIC:



ELECTRICAL SPECIFICATION:

- ◆ Rated Input Current Range = up to 30A
- ◆ Operating Frequency = 20kHz to 200kHz
- ◆ Operating Temp. Range = -40°C to +120°C
- ◆ Prim. to Sec. Isolation = 2.5kV / 50Hz / 2Sec
- ◆ Output Voltage (Us) = 15V @ 15A

MECHANICAL SPECIFICATION:

Bottom / Pin Side View:

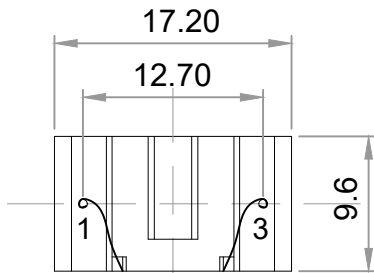

GT Part No.	Turns ratio	L _{sec}	RDC _{sec} Max.	Sec. Terminating resistance	Output Current I _{sec}	Volt time Max.
L01-6230	1:50	6mH	0.6Ω	50Ω	300mA	175μS
L01-6231	1:100	25mH	1.1Ω	100Ω	150mA	350μS
L01-6232	1:200	100mH	4.5Ω	200Ω	75mA	700μS
L01-6233	1:300	250mH	10Ω	300Ω	50mA	900μS
L01-6234	1:500	700mH	25Ω	500Ω	30mA	1500μS

Front View:

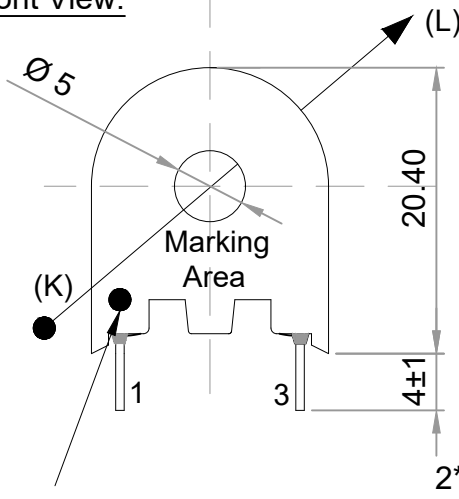

Side View:



Marking Information	weight	SPQ
L01-6230 GT YY/WK	6 g/pc	475 pcs
L01-6231 GT YY/WK	7 g/pc	
L01-6232 GT YY/WK	7 g/pc	
L01-6233 GT YY/WK	6 g/pc	
L01-6234 GT YY/WK	6 g/pc	
L01-6234 GT YY/WK	6 g/pc	

All Dimensions are in mm
Linear Dimensional Tolerance ±0.2mm

 This product may contain harmful substances, it may require proper disposal subject to statutory & regulatory laws defined by the local governance of its own country/region as applicable at the time of disposal.

Date:	Approval of Customer:
-------	-----------------------

-----Initial Issue-----	1	0	D.Kirubakaran	14-09-2024
Changes	Issue	Rev	Prepared	Reviewed Date